



PO2400004940



16/LO/Plg/HMDA/2022

**silpa**  
INFRA TECH

**WORK, LIVE, LEARN and PLAY  
ALL IN ONE PLACE**

**silpa**  
**Botanica**

**331 ACRES INTEGRATED OPEN PLOTS TOWNSHIP**

**250 ft. Road Facing, Srisailam Highway**

[www.silparaghavabotanica.com](http://www.silparaghavabotanica.com)

**MASTER LAYOUT**

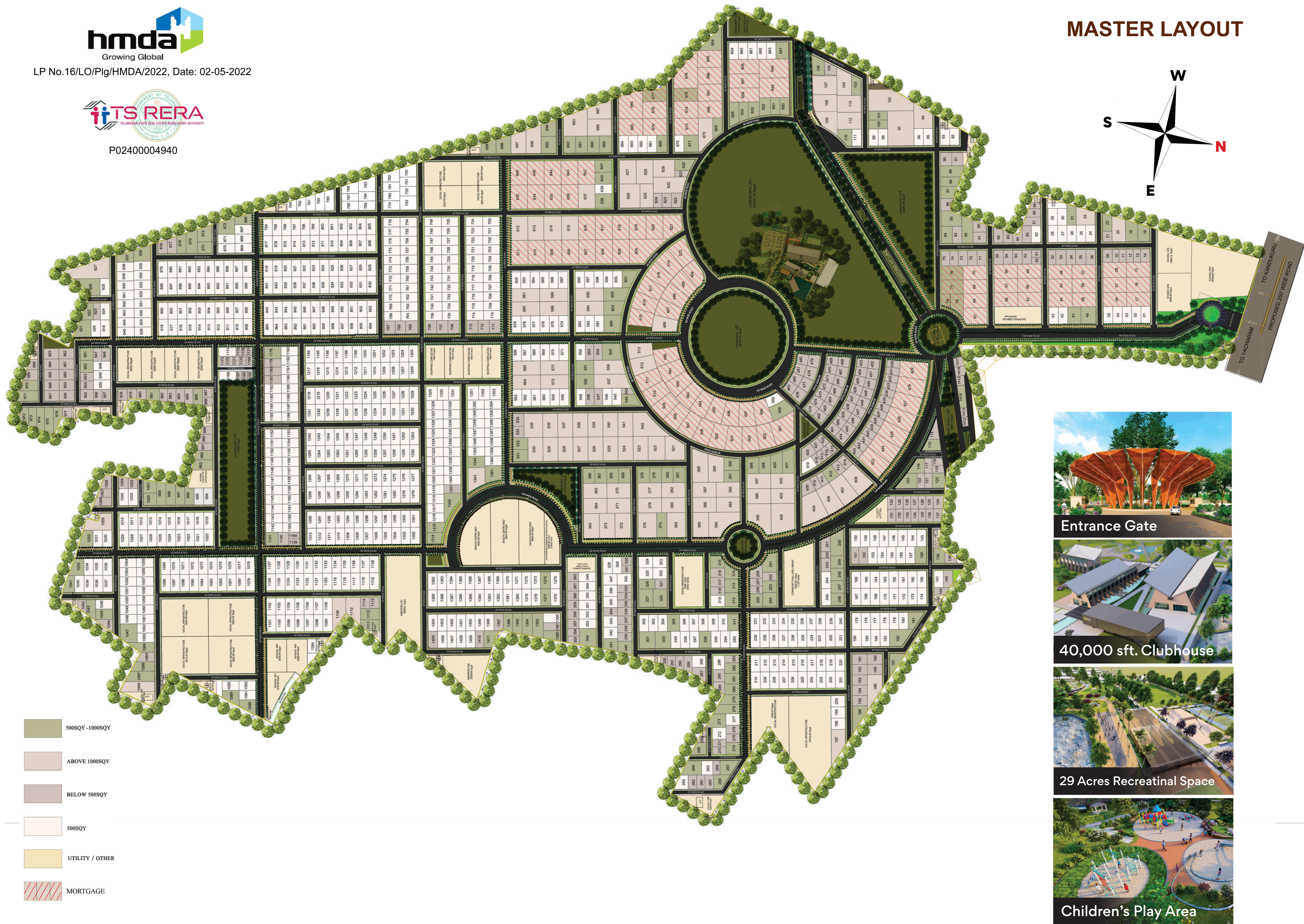
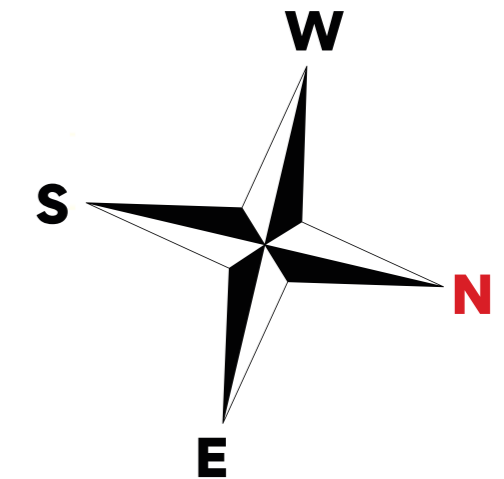

- 500SQY - 1000SQY
- ABOVE 1000SQY
- BELOW 500SQY
- 500SQY
- UTILITY / OTHER
- MORTGAGE



**Entrance Gate**



**40,000 sft. Clubhouse**



**29 Acres Recreational Space**



**Children's Play Area**

# Botanica - an Integrated Township



## Unparalleled Living with 100+ World Class Amenities



### INDOOR & OUTDOOR AMENITIES

Mini Golf | Football Ground | Half Olympic Size Pool | Tennis Court  
 Basketball Court | Landscaped Gardens | Children's Play Area | Senior Seating Area  
 Jogging Track | Cycling Track | Outdoor Gym | Jumbo Chess | Amphitheater  
 Party Lawn | Avenue Plantation | Formal Seating Area | Drive-in Theatre  
 Gymnasium | Board Games | Badminton Court | Library | Restaurant  
 Spa/Saloon | Table Tennis | Snookers and Many More...

### LOCATION ADVANTAGES

- Amazon Data Center - **2 min**
- Kandukur - **6 min**
- Maheswaram - **19 min**
- E-City - **20 min**
- Outer Ring Road - Exit 14 - **22 min**
- RGIA Hyderabad Airport - **30 min**
- Mehdiapatnam - **45 min**
- Financial District & IT Corridor - **45 min**
- Gachibowli - **55 min**

